

Snitt

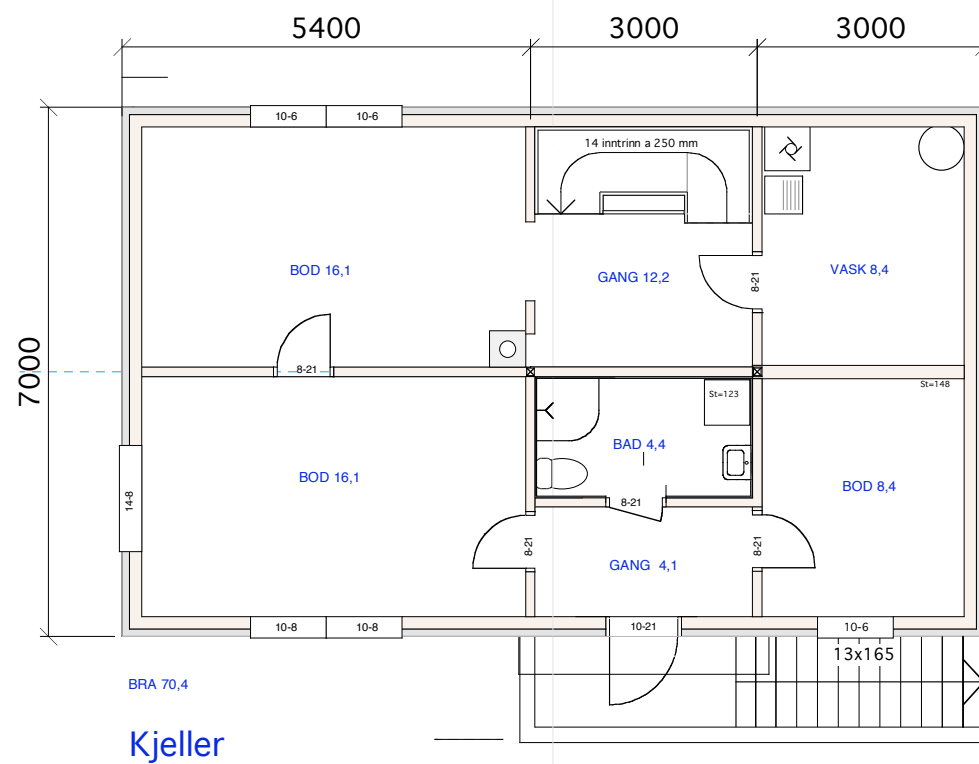

Kjeller

BRA 70,4

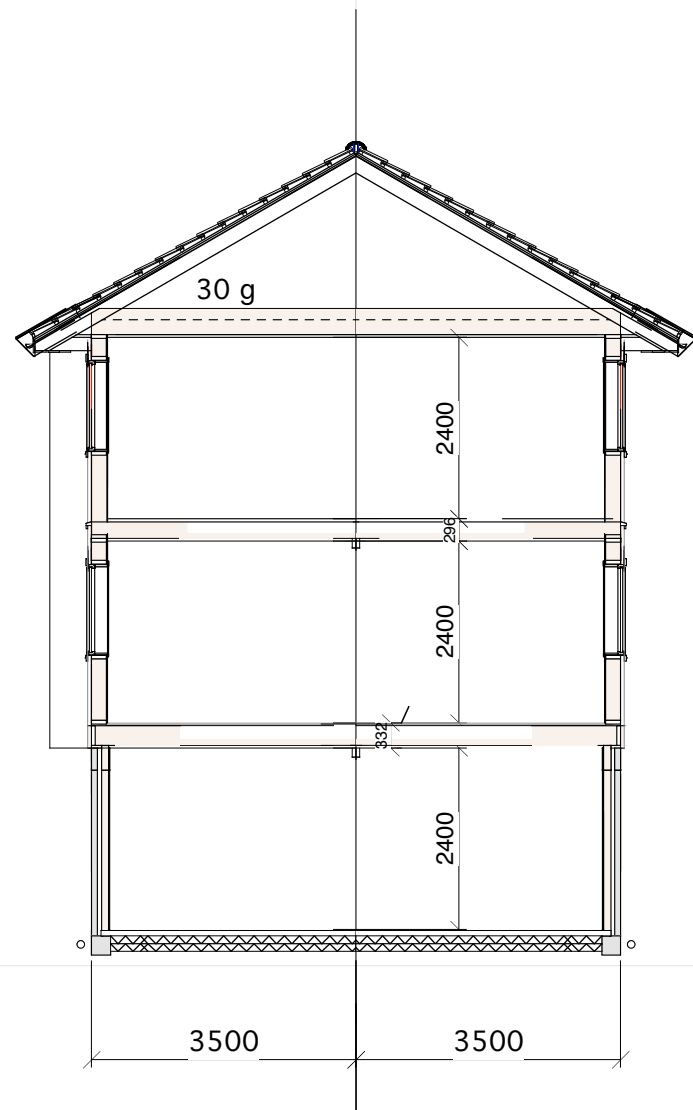
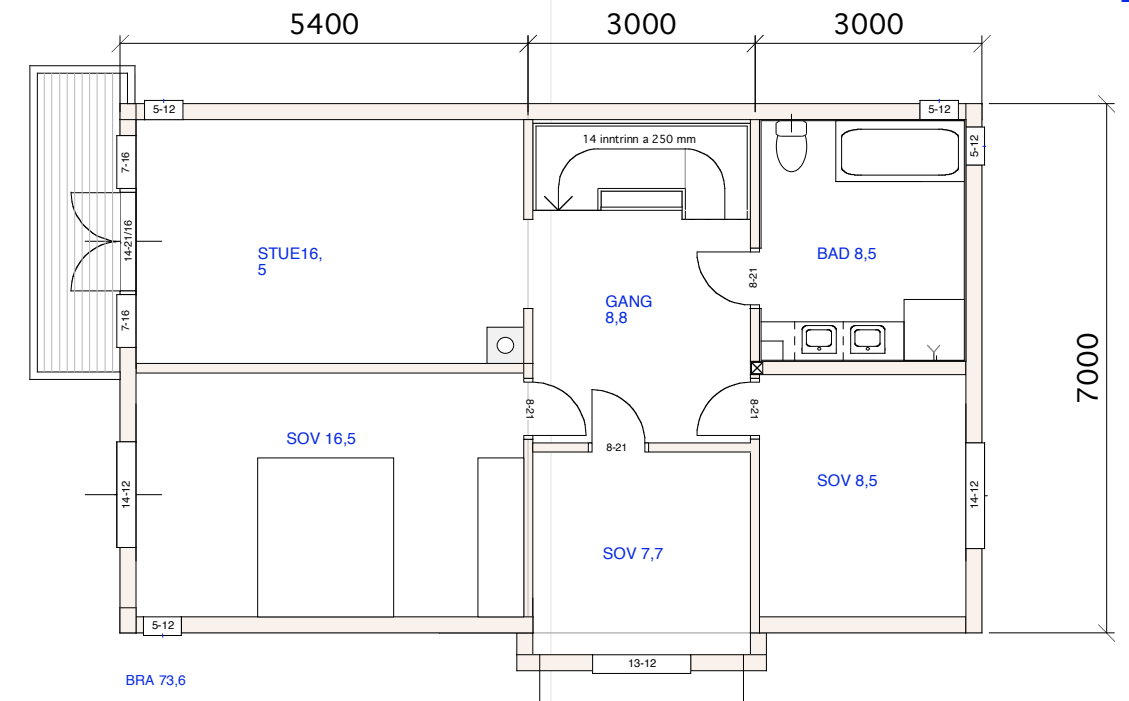

2.ETG

BRA 73,6

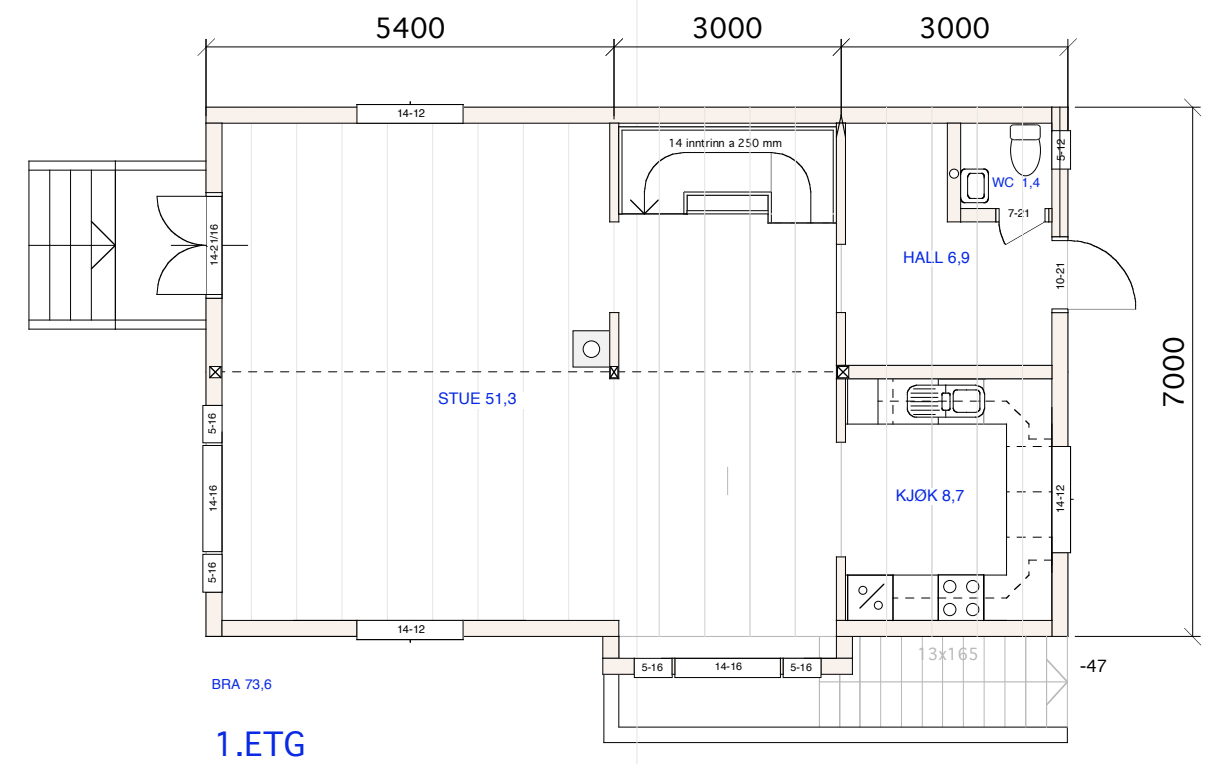

1.ETG

BRA 73,6

BRA 70,4 + 73,6 + 73,6= 217,6

E-1

Gr.flate=81,4 Repos=2,4 Garasje =18,2m Bil på terreng=18,0= Sum=120
 Tomteutnyttelse= 120/500=0,24. Bya= 24,00%



Opprinnelig terreng
 $160,7+160,9$
 $+161,8+161,7=$
 $645,1/4=161,27$
 Gj.snitt oppr terreng.
 Maks gesims= $161,27+ 6,5=167,77$
 Maks møne= $161,27+ 9,0=170,27$

Planert terreng
 Sum areal eksponert gr.mur.
 $1,4+6,2$
 $+6,32+8,2=$
 $22,0/2(7,2+11,4)=0,625$
 Gj.snitt planert terreng:
 $161,9-0,62=161,28$

Gj. planert terreng er 1 cm høyere enn opprinnelig terreng.

Dvs at det ikke er foretatt noen terrengendringer som har endret de naturlige forutsetningene for beregning av høyde eller tomtutnyttelse



